

A serene sunset scene over a calm ocean. The sun is a bright, glowing orb in the upper right corner, casting a warm, golden light across the sky and reflecting on the water's surface. The sky transitions from a deep blue at the top to a lighter, hazy blue near the horizon. The water in the foreground shows gentle ripples and a darker blue hue.

Sunridge

RASHID YACHTS & MARINA

EMAAR

Rashid Yachts & Marina



Rashid Yachts & Marina is the new global destination for discerning yacht owners to experience Dubai's buzzing scene in an elegant environment where beauty and luxury collide. Designed to encapsulate the ultimate modern waterfront architecture, it combines luxury residences and a full-service marina with an appealing mix of restaurants and shops, creating a unique definition of "living at sea".





World-class Superyacht Hub



The new marina at Rashid Yachts & Marina offers convenient, hassle-free access to Dubai, accommodating 430 wet berths for yachts up to 100m long with a range of flexible berthing options, from a single night through to seasonal and annual stays.

The Ultimate in Coastal Living





SEAGATE

SEASCAPE

SUNRIDGE

1 MARINA, PROMENADE
& DUBAI MALL BY THE SEA

2 THE CANAL POOL

3 QE2

4 HOSPITALITY ON THE WATER

5 FOUNDER'S HOUSE

6 PEDESTRIAN BRIDGE

7 THE MUSEUM

8 FLOATING RESTAURANTS

9 MARINA / YACHT BERTHS

10 THE THEATRE

11 FERRY STATION

12 BOUTIQUE HOTEL

13 PRIVATE BEACH CLUB

Shopping, Dining & Inspiration



When it comes to retail therapy, nobody does it better than Dubai. The nearby Downtown Dubai is the city's most famous shopping district, and it's packed with chic boutiques that will satisfy your every fancy. Rashid Yachts & Marina's promenade has floating restaurants, cafés, lounges, and beach bars, while downtown Dubai is home to the city's top dining and nightlife options and is conveniently located just a short distance away.





A Thriving Promenade



During the day, or long after the sun dips beyond the sea's horizon, the Promenade is the essence of the Marina's thriving life with a rich variety of dining options and an eclectic selection of stylish shops that will accommodate your every need. So just sit back, relax, and enjoy life.

Welcome to
Sunridge



Luxury Haven

Experience the ideal combination of luxury and style with breathtaking views of the Marina and the Arabian Gulf's blue horizon. In this coastal luxury haven, you can indulge in extended vacations while basking in the stunning combination of warm weather, world-class shopping, modern architecture, sandy beaches, and the most cosmopolitan way of life.



Coastal Living at its Best



Sunridge offers a fine collection of premium 1 & 2-bedroom homes steps away from the Marina, the Promenade and Dubai's longest swimmable canal pool. Dive into the good life in a contemporary residential oasis offering sophisticated amenities, tranquil surroundings, and exciting nearby attractions.





Inspired Elegance



Each of Sunridge's modern residential units is a masterpiece of detail and design. Choose between expansive 1 & 2-bedroom apartments with open floorplans and panoramic windows offering endless outdoor living space views reflected in the perfectly balanced interiors colour palette.

Leisure & Relaxation



Directly adjacent to the community park and the canal pool, with direct access to the lushly landscaped promenade brimming with life and offering excellent views of the marina and the Dubai skyline. Dip your toes in the 500-metre-long canal pool lined with palm trees and cabanas, or benefit from the complex's own gym and pool facilities. Sunridge is the place where you can do all that and much more.

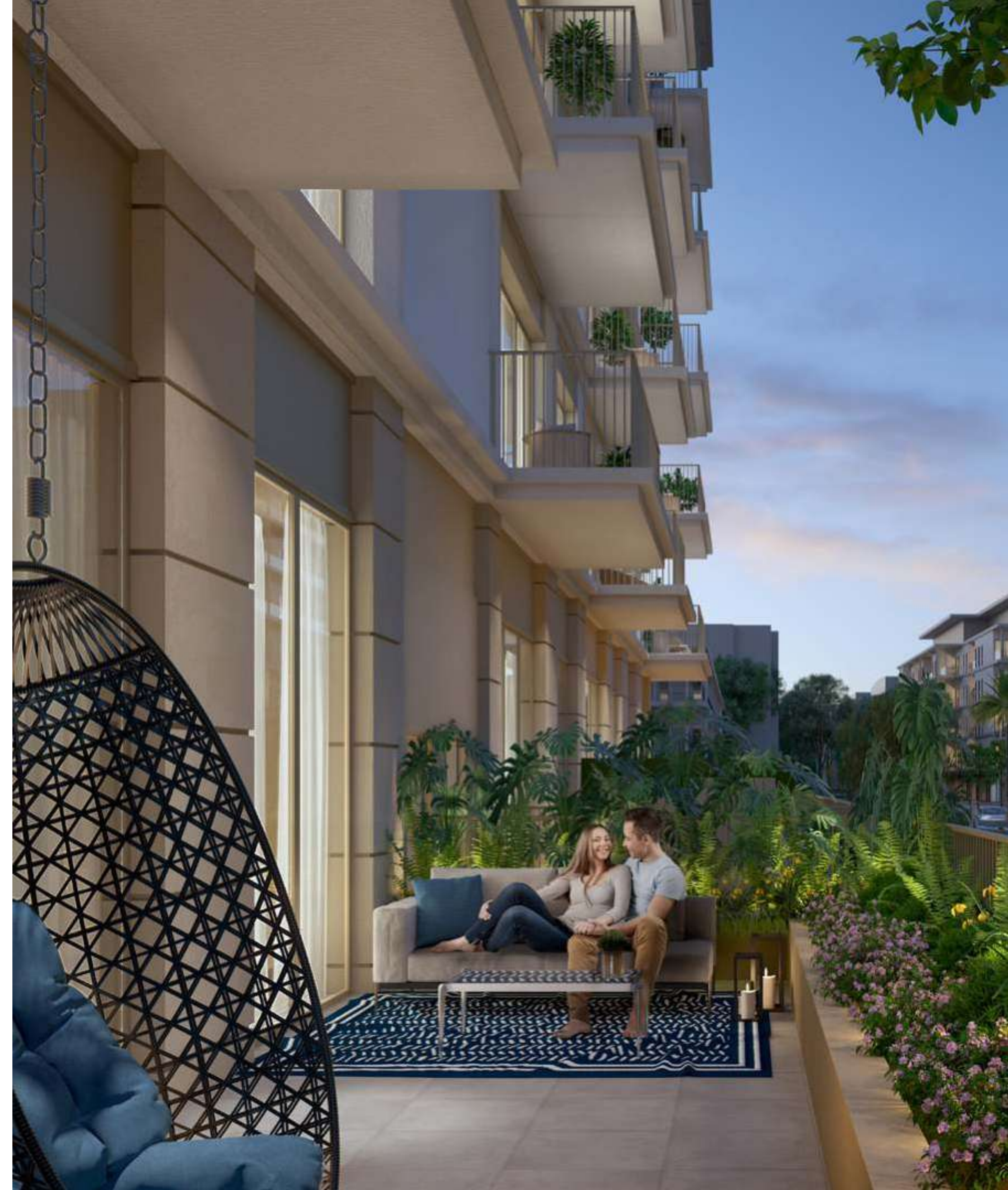



Elevated Urban Living



- 1 Marina Promenade
- 2 Burj View axis
- 3 High Street (Local Shops & Cafe's)
- 4 Neighbourhood Park & Plaza
- 5 Sikkas
- 6 Linear Edge Leisure & Wellness Park
- 7 Residential cluster with Pool & Gardens
- 8 Marina Retail Parade
- 9 Launch
- 10 Marina

Pool Canal



Boardwalk Promenade





Community Park



Recreational Courts



Retail & Dining



Global Lifestyle Developer

A leader in the global real estate market, EMAAR has grown over the years to become the largest real estate developer outside of China. You will be investing with one of the best-regarded brands in the world*.

51.8BN AED
Market Cap - FY 2022

24.9BN AED
Revenue as of Dec. 2022

6.8BN AED
Net Profit - FY 2022

85,000
Residential Units Delivered

12+
Global Market Presence

27,000
Residential Units Currently Under Development

* As in 31 December 2022



TANAMI
P R O P E R T I E S

CONTACT US

 +971 4 248 3400 |  +971 55 162 3236

Email Us

info@tanamiproperties.ae

For More Info...

www.tanamiproperties.com/Projects/Emaar-Sunridge-Mina-Rashid



ADDRESS

Office 3405, Marina Plaza,
Al Marsa Street, Dubai Marina, UAE